

healthy homes that change lives...

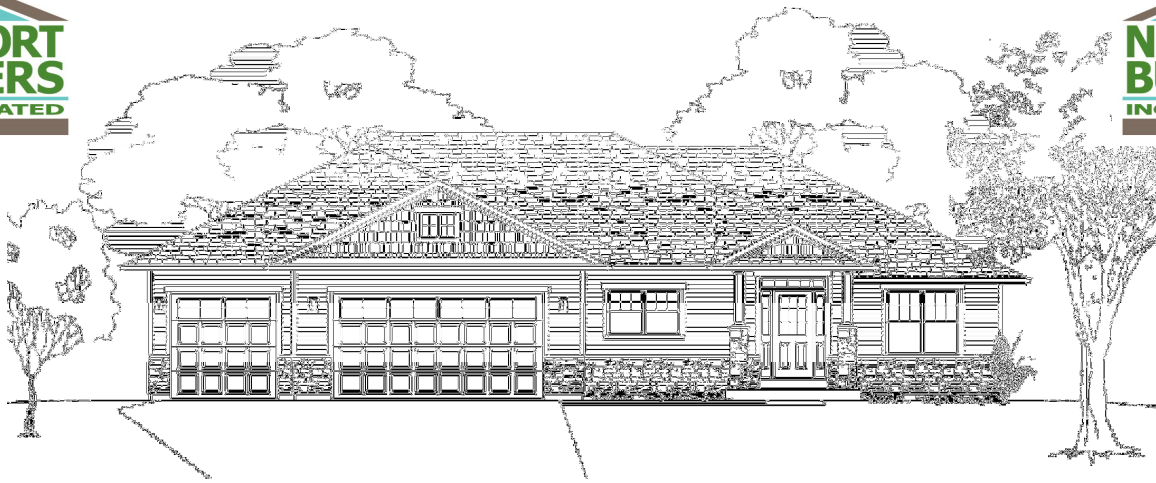

THE SOUTHPORT 6442 Heritage Ave

Jamestown V Community,
Village of Mt. Pleasant

1,803 Sq. Ft. on main level
1,162 Sq. Ft. on lower level

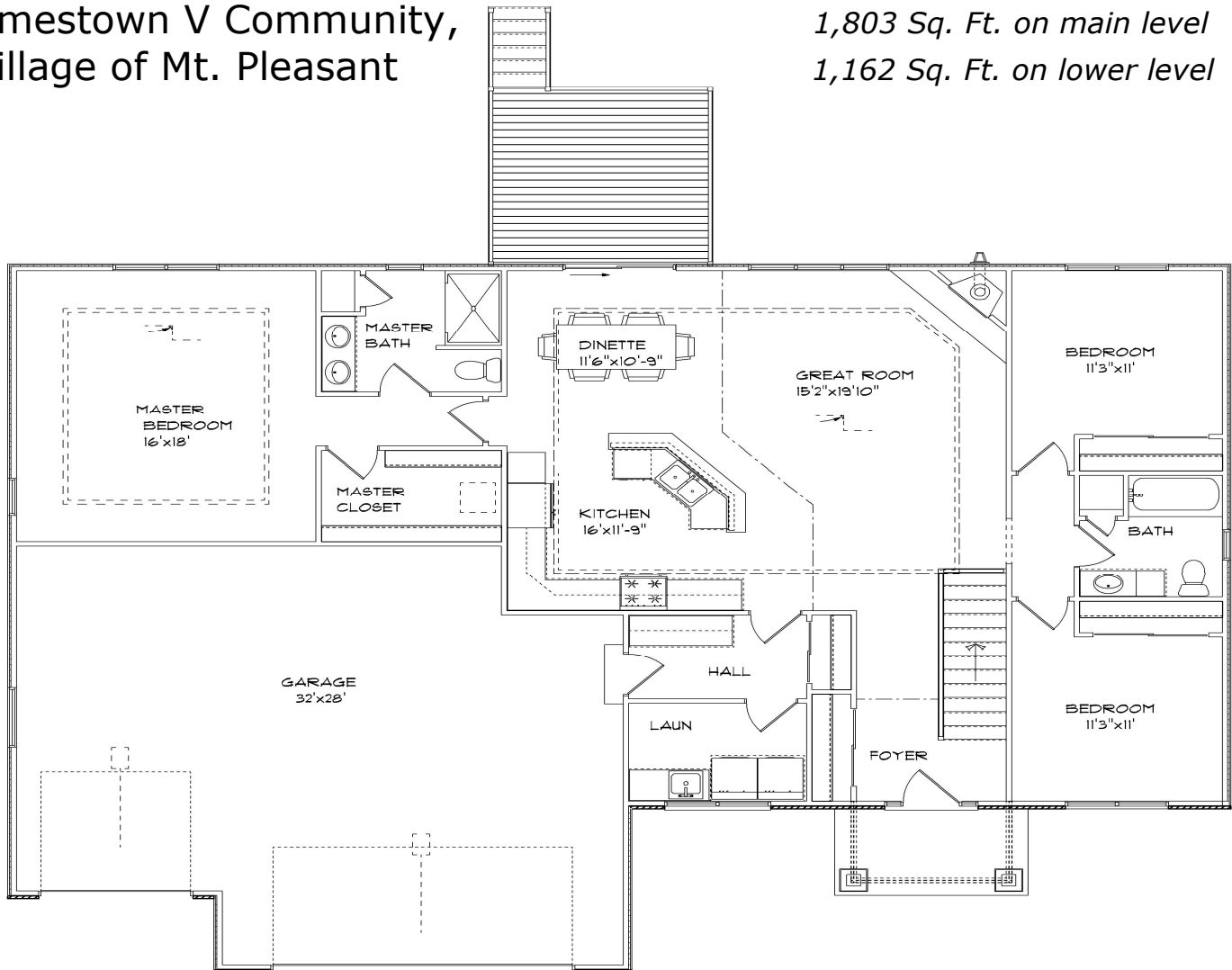

*** Elevation may vary slightly ***

Amenities included

- Vinyl double hung windows w/low-e
- Power vented 50 gallon hot water heater
- Energy efficient direct vent gas fireplace
- Steel garage door
- 2-panel pine doors & pine trim
- Schlage®, satin nickel “Accent” style lever door hardware
- Maple cabinets with staggered height & depth in kitchen with crown molding
- Tall vanity in master bathroom
- Quartz countertops in kitchen w/glass tile backsplash
- L.G. Hi-Macs solid surface countertops in bathrooms
- High definition laminate countertops in laundry room, drop zone area and basement bath
- Carpet, vinyl & hardwood floors
- Focus on Energy rated stainless steel dishwasher & space saver micro/range hood vented to the outside
- 3rd party air infiltration diagnostic testing
- 95% Comfort System w/10 year parts & labor warranty
- Concrete driveway and walk
- **CERTIFIED FOCUS ON ENERGY & GREEN BUILT HOME**

For more information on additional home sites in this community please contact Craig Kasianowicz

Newport Builders, Inc.
6949 Mariner Dr.
Racine, WI 53406

262-770-6246 • 262-632-7373
craig@newport-builders.com

